

The Clipper Hi-Cap 768



Technical Specifications

- Extreme Height 138" / 351 cm
- Extreme Width 89" / 226 cm
- Extreme Length 189" / 480 cm
- Width on floor 72" / 183 cm
- Length on floor 189" / 480 cm

Electrical Requirements

- Main Fan Motor 15 HP, 3 Phase, AC
- Eccentric Motor 5 HP, 3 Phase, AC
- Vibratory Feeder ½ HP, AC or DC

Air Output

- Integral Centrifugal Fan delivering up to 8,400 CFM @ 8" S.P

Features

- Heavy Duty Construction-Built to last
- Electronic Vibratory Feed Hopper
- Screen Pitch: Top Shoe 8° Bottom Shoe 12°
- Uses Standard Size Clipper Screens: 25 Screen Sections of 54" x 26"
- Feed Hopper & Aspiration Column Engineered for High Capacity

Capacity

- Large Seed & Wheat 2,000 Bu./Hr. (54 MT/H)
- Market Cleaning 3,000 Bu./Hr. (81 MT/H)

Options

- Bottom Blast Fan incorporated in a separate bottom frame adds 17" (43 cm) to Extreme Height

Note: Capacities may vary depending on seed condition, moisture content, seed varieties, types and volumes of contaminants to be separated and the percentage of foreign material acceptable in the final product.



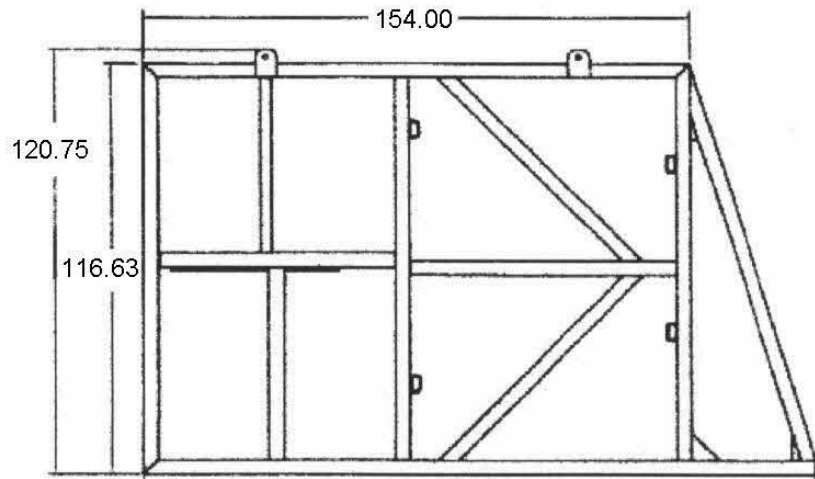

SIDE VIEW

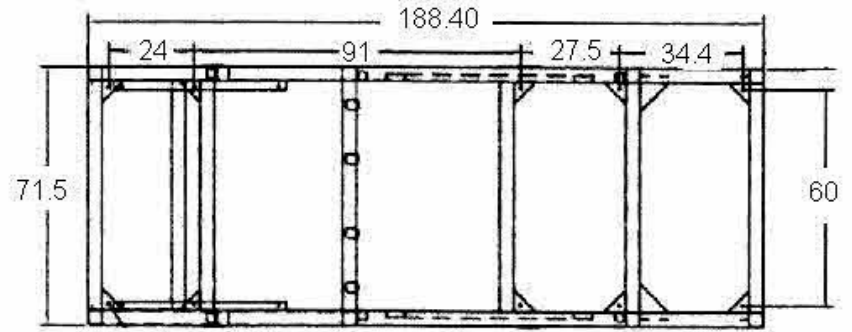

BOTTOM VIEW

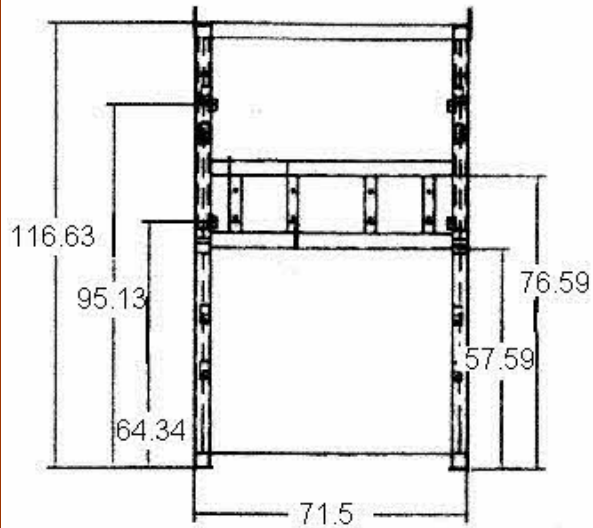

FRONT VIEW

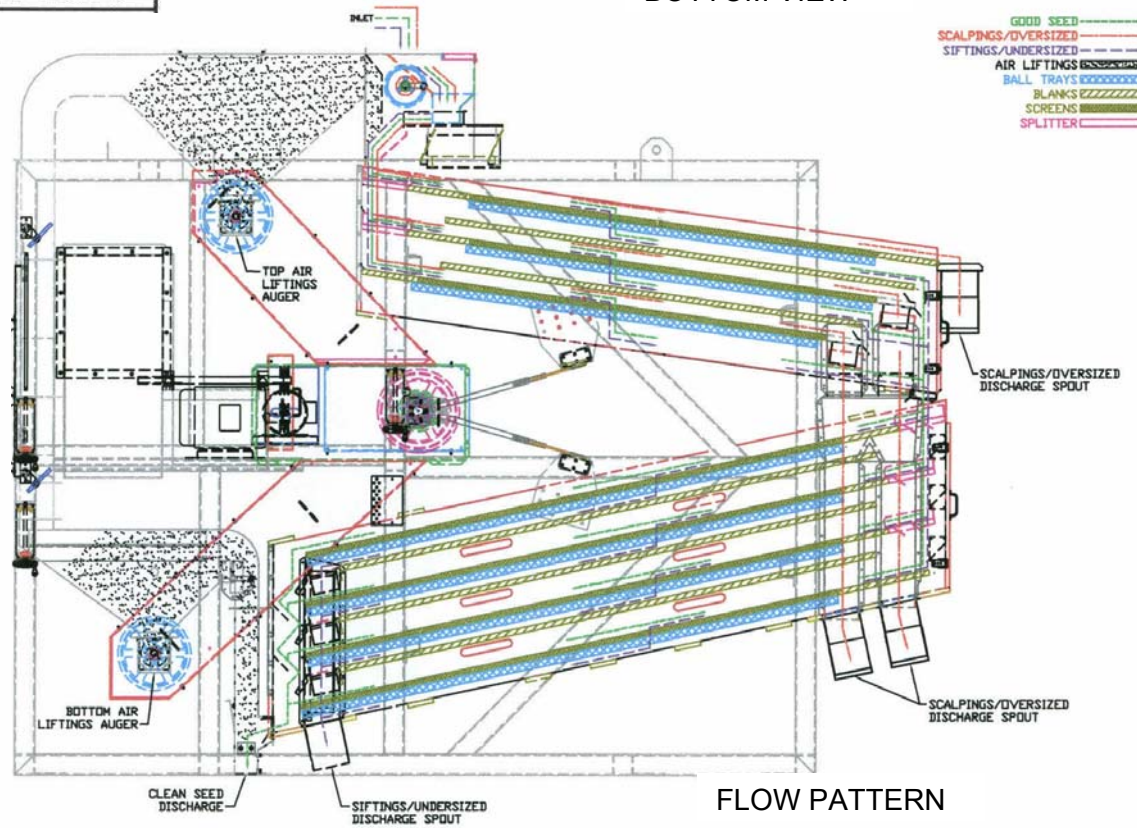

- GOOD SEED
- SCALPINGS/OVERSIZED
- SIFTINGS/UNDERSIZED
- AIR LIFTINGS
- BALL TRAYS
- BLANKS
- SCREENS
- SPLITTER

FLOW PATTERN