

REVISION HISTORY				
REV	ECN	DESCRIPTION	DATE	APPROVED
A	XXXXXX	RELEASE	11/9/1951	Loehr
B	F120129	WAS C SIZE GROUP DRAWING, F03500340 WAS F03500310	12/4/2012	dmjohnson

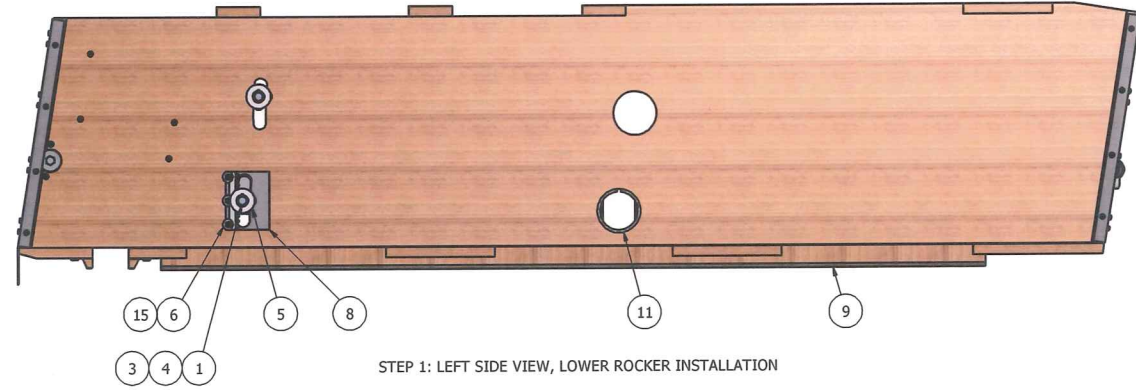

STEP 1: LEFT SIDE VIEW, LOWER ROCKER INSTALLATION



SCALE 1/8

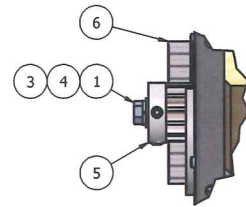

DETAIL A
SCALE 0.38 : 1

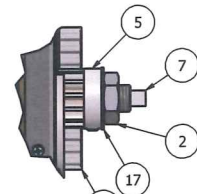

DETAIL B
SCALE 0.38 : 1

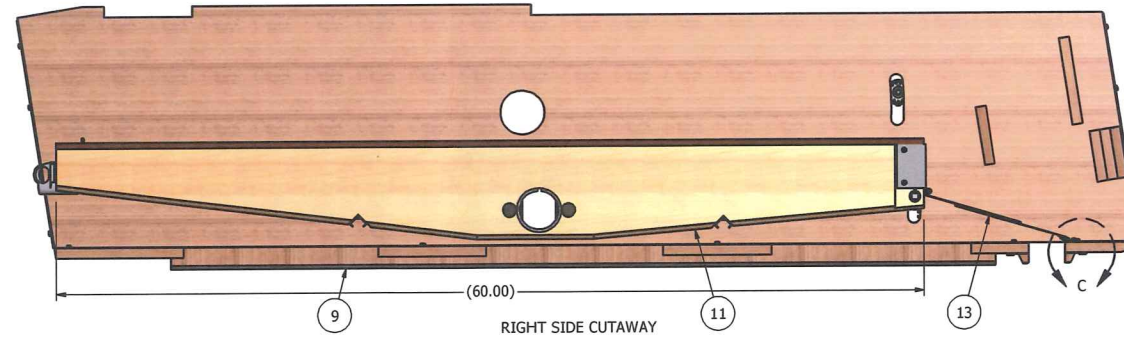

RIGHT SIDE CUTAWAY

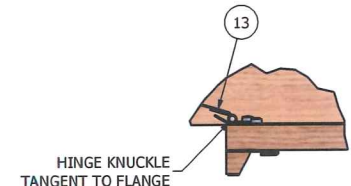

DETAIL C
SCALE .38:1

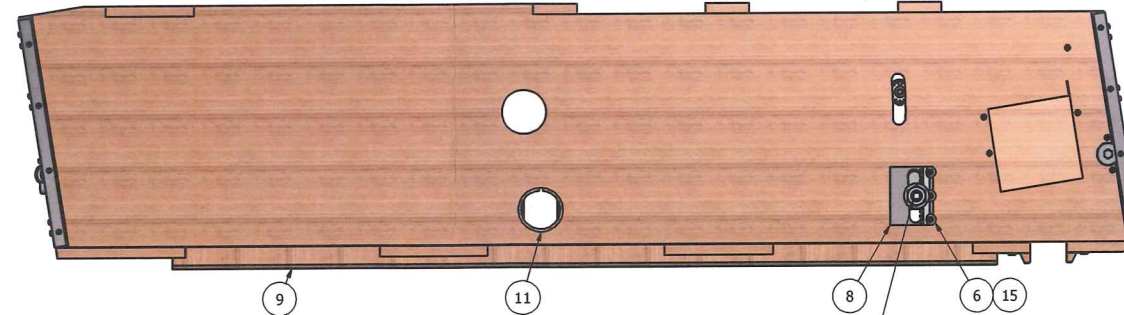
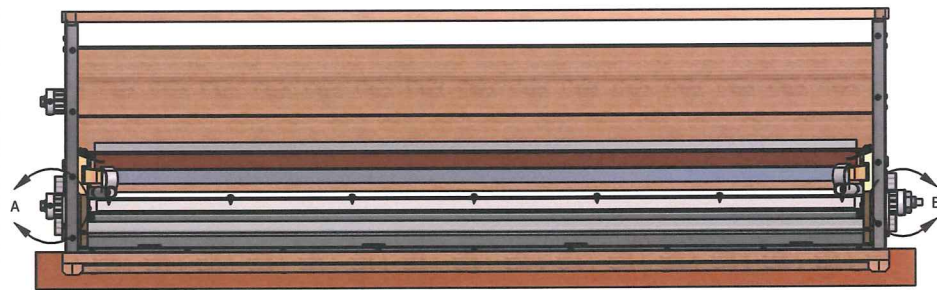

STEP 1: RIGHT SIDE VIEW, BOTTOM ROCKER INSTALLATION

ITEM	PART NUMBER	QTY	DESCRIPTION
*	18	SALES ORDER	2 FRAME ASSY, PERF SCREEN, 60" X #8
	17	F84621034	2 WASHER, FLT .750 X 1.750 X .062
	16	F83451201	11 SMS, PAN X HD, #8 X 1/2"
	15	F83450101	12 SMS, PAN X HD, #8 X 1.00"
*	14	F08308810	1 SPOUT, RH STRAW, X298
	13	F03804976	1 APRON ASSY, TELESCOPING, BTM ROCKER, 68D
	12	F03804975	1 APRON ASSY, TELESCOPING, TOP ROCKER, 68D
	11	F03500340	1 ROCKER ASSY, BOTTOM, BOTTOM SHOE, 68A & D
	10	F03500210	1 ROCKER ASSY, TOP, BOTTOM SHOE, 298D
	9	F03008130	1 SHOE ASSY, BOTTOM RH, 68A & D
	8	F01801700	4 PLATE, ESCUTCHCHEON, TILT ROD ROCKER
	7	F01608303	2 SHAFT, TILTING ROD, 3/4 X 60.50" #8
	6	F01200300	4 RACK, STRAIGHT ROCKER ADJUSTING
	5	F01200203	4 PINION, BRUSH ADJ. 13 TOOTH W/SET SCREWS
	4	66444400	2 WASHER, LOCK HELICAL 3/8"
	3	66404400	2 WASHER, FLAT 3/8" NARROW TYPE A
	2	66276400	2 NUT, HEAVY HEX JAM 3/4-10
	1	62584422	2 HHCS, 3/8-16 X 1.00"

- NOTES:
 1. DO NOT SCALE FROM DRAWING.
 2. ONE PIECE REQUIRED PER F40400682/84: CLEANER ASSY, RH BT 900RPM W/O VSS / W/ VSS, 68D.
 3. * LINE ITEM ON SALES ORDER. NOT INCLUDED IN BILL OF MATERIAL.

		DIVISION OF A.T. FERRELL COMPANY 1440 S ADAMS ST BLUFFTON, INDIANA 46714 - USA PH: 260-824-5400 FAX: 260-824-5463		This drawing is the property of the A.T. Ferrell Company, Inc and must be returned immediately upon request. No part of this drawing may be reproduced, stored in a retrieval system or transmitted in any form or by any means, without prior written consent of the A.T. Ferrell Company, Inc.	
TOLERANCES EXCEPT AS NOTED DECIMAL: XX ± .030 XXX ± .005 XXXX ± .001		FRACTIONAL: ± 1/32 FINISH: NONE ANGULAR: ± 1/2°		TITLE: SHOE ASSY, RH BOTTOM W/ROCKERS, 68A & D	
CAD NO MANUAL CHANGES		SCALE: 0.16:1		SHEET: 1 OF 2	
SIZE: D		PART NUMBER: F03008107		REV: B	

REVISION HISTORY				
REV	ECN	DESCRIPTION	DATE	APPROVED
A	XXXXXX	RELEASE	11/9/1951	Loehr
B	F120129	WAS C SIZE GROUP DRAWING, F03500340 WAS F03500310	12/4/2012	dmjohnson

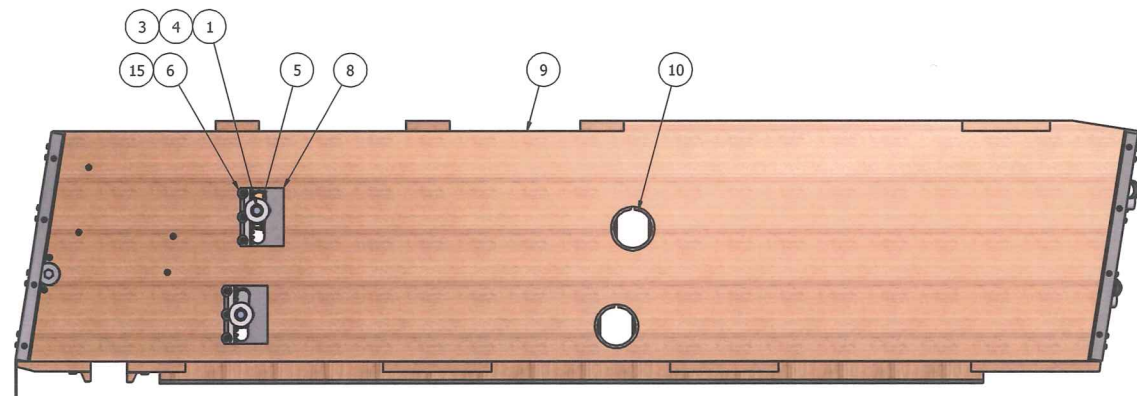

STEP 2: LEFT SIDE VIEW, UPPER ROCKER INSTALLATION, COMPLETE

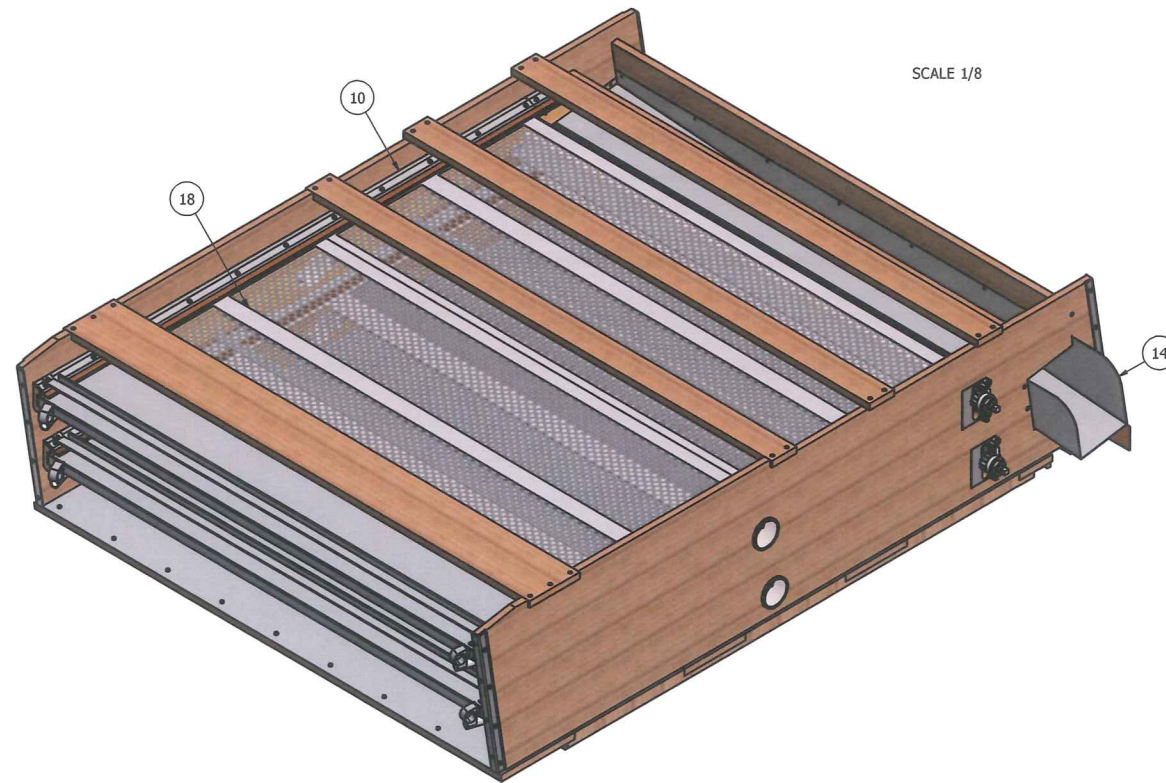

SCALE 1/8

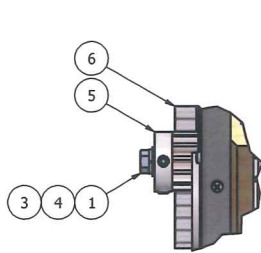

DETAIL D
SCALE 0.38 : 1

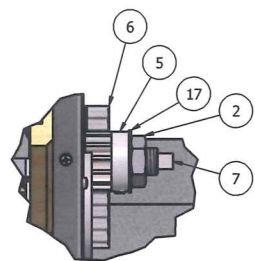

DETAIL E
SCALE 0.38 : 1

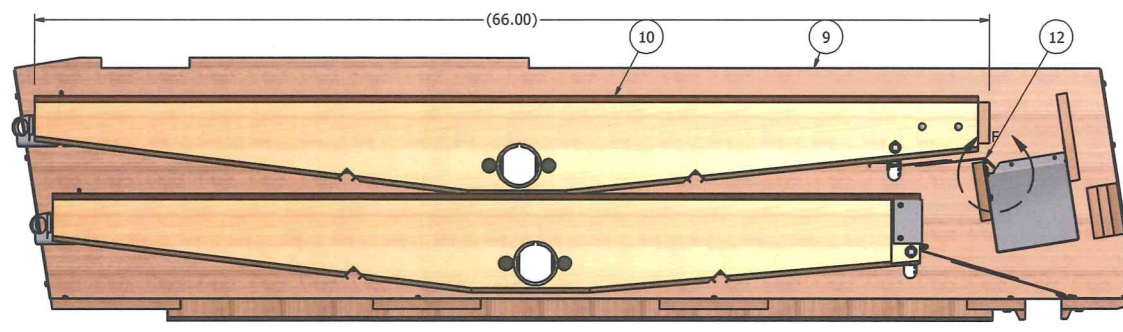

RIGHT SIDE CUTAWAY

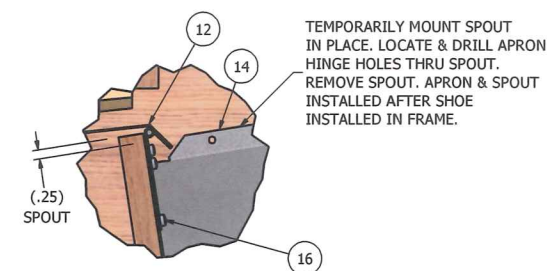

DETAIL F
SCALE 0.38 : 1

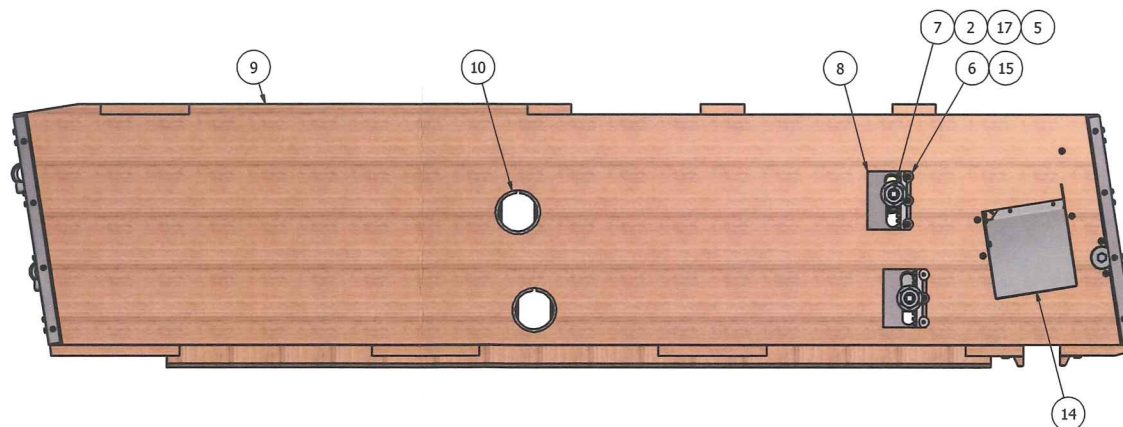
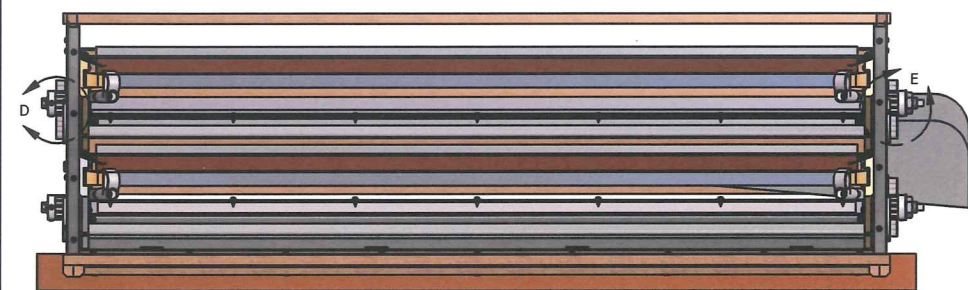

STEP 2: RIGHT SIDE VIEW, UPPER ROCKER INSTALLATION

ITEM	PART NUMBER	QTY	DESCRIPTION
* 18	SALES ORDER	2	FRAME ASSY, PERF SCREEN, 60" X #8
17	F84621034	2	WASHER, FLT .750 X 1.750 X .062
16	F83451201	11	SMS, PAN X HD, #8 X 1/2"
15	F83450101	12	SMS, PAN X HD, #8 X 1.00"
* 14	F08308810	1	SPOUT, RH STRAW, X298
13	F03804976	1	APRON ASSY, TELESCOPING, BTM ROCKER, 68D
12	F03804975	1	APRON ASSY, TELESCOPING, TOP ROCKER, 68D
11	F03500340	1	ROCKER ASSY, BOTTOM, BOTTOM SHOE, 68A & D
10	F03500210	1	ROCKER ASSY, TOP, BOTTOM SHOE, 298D
9	F03008130	1	SHOE ASSY, BOTTOM RH, 68A & D
8	F01801700	4	PLATE, ESCUTCHCEON, TILT ROD ROCKER
7	F01608303	2	SHAFT, TILTING ROD, 3/4 X 60.50" #8
6	F01200300	4	RACK, STRAIGHT ROCKER ADJUSTING
5	F01200203	4	PINION, BRUSH ADJ. 13 TOOTH W/SET SCREWS
4	66444400	2	WASHER, LOCK HELICAL 3/8"
3	66404400	2	WASHER, FLAT 3/8" NARROW TYPE A
2	66276400	2	NUT, HEAVY HEX JAM 3/4-10
1	62584422	2	HHCS, 3/8-16 X 1.00"

NOTES:
1. DO NOT SCALE FROM DRAWING.
2. ONE PIECE REQUIRED PER F40400682/84: CLEANER ASSY, RH BT 900RPM W/O VSS / W/ VSS, 68D.
3. * LINE ITEM ON SALES ORDER. NOT INCLUDED IN BILL OF MATERIAL.

	DIVISION OF A.T.FERRELL COMPANY 1440 S ADAMS ST BLUFFTON, INDIANA 46714 - USA PH: 260-824-3400 FAX: 260-824-5463	This drawing is the property of the A.T. Ferrell Company, Inc and must be returned immediately upon request. No part of this drawing may be reproduced, stored in a retrieval system or transmitted in any form or by any means, without prior written consent of the A.T. Ferrell Company, Inc.
	DRAWN BY: dmjohnson	DRAWN DATE: 12/4/2012
TOLERANCES EXCEPT AS NOTED: DECIMAL: XX ± .030 XXX ± .005 XXXX ± .001	TITLE: SHOE ASSY, RH BOTTOM W/ROCKERS, 68A & D	FINISH: NONE
CAD NO MANUAL CHANGES	SCALE: 0.16:1	SHEET: 2 OF 2
SIZE: D	PART NUMBER: F03008107	REV: B